



Steering, Brake & Suspension Specialists

#20036 - Parking Brake Cable Extension Installation Instructions (used with Big Brake Applications)

Parts:

- 2 ea Extension Sleeves
- 2 ea E-Clips

Note:

Read these instructions completely before attempting this conversion.

Make sure this kit fits your application before painting or plating. Parts that have been painted, plated or modified may not be returned.

Instructions:

- 1** Install the threaded portion of the extension sleeve through the parking brake hole on the caliper.
- 2** Install the E-clip on to the threads of the extension sleeve.
- 3** Install the parking brake cable through the extension sleeve.
- 4** Connect the parking brake cable to the parking brake lever on the caliper.
- 5** Connect and adjust the other end of the parking brake cable.

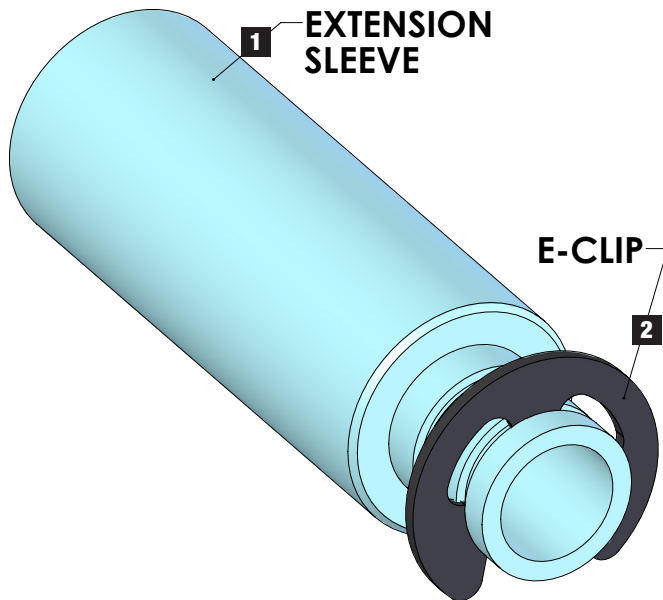

PLEASE NOTE: The installer needs to make sure that nothing can make contact with a brake hose, caliper, or other brake component at any point through the entire range of steering and suspension movement. The installer also needs to make sure none of the steering or braking components can become bound or jammed at any time through the range of suspension or steering movement.

GENERAL TORQUE SPECIFICATIONS:					
1/4"	grade 5	10 lb/ft	1/4"	grade 8	14 lb/ft
5/16"	grade 5	19 lb/ft	5/16"	grade 8	29 lb/ft
3/8"	grade 5	33 lb/ft	3/8"	grade 8	47 lb/ft
7/16"	grade 5	54 lb/ft	7/16"	grade 8	78 lb/ft
1/2"	grade 5	78 lb/ft	1/2"	grade 8	119 lb/ft
9/16"	grade 5	114 lb/ft	9/16"	grade 8	169 lb/ft
5/8"	grade 5	154 lb/ft	5/8"	grade 8	230 lb/ft

NOTE: With 18" and larger wheels we recommend 1/2" wheel studs. The larger the wheel diameter, the greater the force is on the wheel studs. Please inquire about replacement wheel stud kits available from CPP.