



Steering, Brake & Suspension Specialists

#6465WBK-S, #6567WBK-S, #6472WBK-SS, #6769WBK-SS, #6874WBK-SS

Super Street Disc Brake Kit Instructions

Notes:

Read these instructions completely before attempting this conversion.

BEFORE BEGINNING INSTALLATION, MAKE SURE YOUR WHEELS FIT ON THE DISC ROTOR. Make sure this kit fits your application before painting or plating. Parts that have been painted, plated or modified may not be returned.

Instructions:

1. Remove the drum brake assembly including the backing plate so all that remains is the spindle. Inspect the spindles for grooves and cracks caused by excessive wear from the old bearings. Worn spindles must be replaced before continuing with the installation.
2. Bolt the caliper mounting bracket to the engine side of the spindle. Attach the steering arm pointing toward the rear of the vehicle placing the provided short spacer between the spindle's front lower mounting hole and the steering arm.
3. It is recommended that Loc-Tite adhesive sealant be used on the top 3/8" Allen head mounting bolt. No sealant is necessary for the two lower bolts.
4. Attach the aluminum hub to the rotor with the supplied 3/16" Allen bolts using Loc-Tite, torque these bolts to 7-9 ft. lbs. Install the inner bearing and seals and place the rotor on the spindle. Install the outer bearing, washer and spindle nut.
5. Slide the caliper onto the bracket with the bleeder up. The caliper may not slide into place due to a bump in the casting next to the piston bore. In some cases, it will be necessary to grind this bump flush using a bench grinder. It may also be necessary to grind away a small portion of the caliper where the brake hose mounts to allow the new banjo-fitted brake hose to be installed so it does not interfere with the spindle. In some cases, it may also be necessary to grind the spindle near the anchor bolt boss for proper bracket fit. Reinstall the caliper and turn the spindle full lock left and right to check for any interference. Loc-Tite is also recommended for the caliper mounting screws.

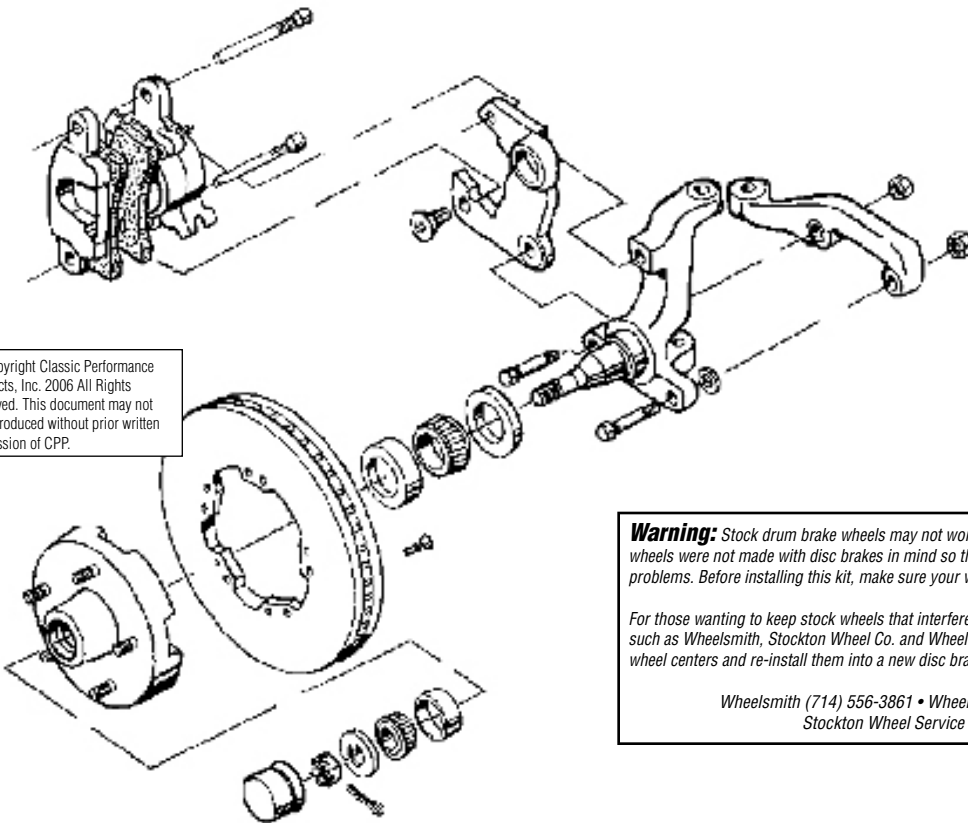

© Copyright Classic Performance Products, Inc. 2006 All Rights Reserved. This document may not be reproduced without prior written permission of CPP.

Warning: Stock drum brake wheels may not work with disc brake conversions. Drum brake wheels were not made with disc brakes in mind so there may be wheel to caliper clearance problems. Before installing this kit, make sure your wheels fit the brake assembly.

For those wanting to keep stock wheels that interfere with the installation, there are companies such as Wheelsmith, Stockton Wheel Co. and Wheel Vintiques that can remove the original wheel centers and re-install them into a new disc brake rim. Please call for more information.

Wheelsmith (714) 556-3861 • Wheel Vintiques (209) 251-6957 •
Stockton Wheel Service (209) 464-7771

For technical help call Classic Performance Products Monday thru Friday 8:30am to 5:00pm at (714) 522-2000.

Classic Performance Products, Inc. 714.522.2000 | fax 714.522.2500

378 E. Orangethorpe Ave. | Placentia, CA 92870 | www.classicperform.com