

# #7387RSRB Installation Instructions

## 1973-87 C-10 Rear Upper Shock Mount Reinforcing Kit

### Parts List:

- 2 ea Shock Mount Bracket
- 4 ea 3/8-16x1 Gr. 8 Bolt
- 4 ea 3/8-16 Gr. 5 Nut
- 4 ea 3/8 Lock Washer
- 8 ea 3/8 Flat washer

### Note:

CPP recommends replacing the shock mounting studs (#CPMS).

### Instructions:

1. Remove the nut from the upper shock mounting stud.
2. Slide the new shock bracket over the end of the shock mounting stud and tighten the nut.
3. Using the new shock mounting bracket as a guide, drill two holes in the side of the frame.

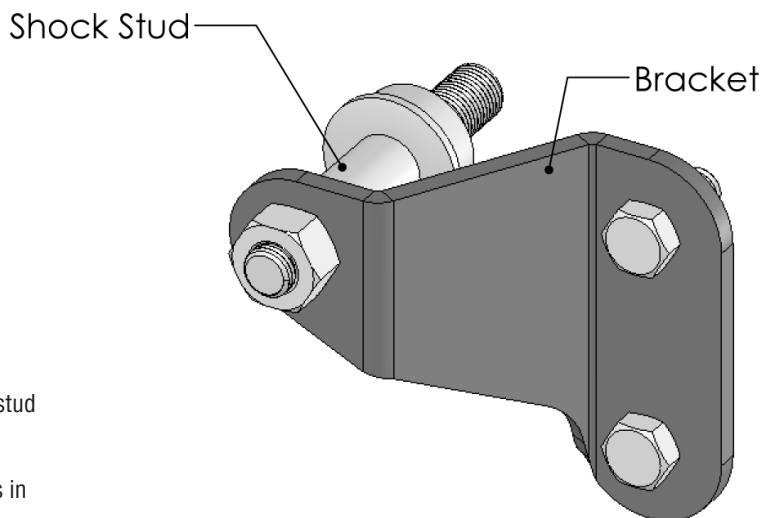

4. Bolt the shock mounting bracket to the frame using the new 3/8" hardware.

GENERAL TORQUE SPECIFICATIONS:					
1/4"	grade 5	10lb/ft	1/4"	grade 8	14lb/ft
5/16"	grade 5	19lb/ft	5/16"	grade 8	29lb/ft
3/8"	grade 5	33lb/ft	3/8"	grade 8	47lb/ft
7/16"	grade 5	54lb/ft	7/16"	grade 8	78lb/ft
1/2"	grade 5	78lb/ft	1/2"	grade 8	119lb/ft
9/16"	grade 5	114lb/ft	9/16"	grade 8	169lb/ft
5/8"	grade 5	154lb/ft	5/8"	grade 8	230lb/ft