



Steering, Brake & Suspension Specialists

# #6467WBK-S - Installation Instructions for 1962-67 GM "X" Body 10.75" Brake Kit

### Parts List:

1 ea	Left Brake Bracket	2 ea	Anchor Bolt Bushings
1 ea	Right Brake Bracket	2 ea	5/8-18 Anchor Bolts
1 ea	Left Caliper Assembly	2 ea	1/2-20 Anchor Bolts
1 ea	Right Caliper Assembly	2 ea	1/2-20x3" Steering Arm Bolts
2 ea	10.75" Rotors	2 ea	7/16-20x3 Steering Arm Bolts
2 ea	Outer Wheel Bearings	2 ea	1/2-20 Self Locking Nuts
2 ea	Spindle Washers	2 ea	7/16-20 Self locking Nuts
2 ea	Spindle Nuts	2 ea	Cotter Pins
2 ea	Brake Hoses	2 ea	10mm Banjo Bolts
2 ea	Brake Hose Clips	4 ea	10mm Banjo Bolt Washers
2 ea	Spindle Dust Caps		

### Instructions:

1. Disconnect the brake hoses from the hard line. (New brake hoses are included with the disk brake kit.)
2. Remove the drums, hubs, and the backing plates.
3. Install the new brake brackets using either the new 5/8-18, or 1/2-20 anchor bolts. When using the 1/2-20 anchor bolt you must also use the anchor bolt bushings. Install the new 1/2-20x3", or the 7/16-20x3" steering arm bolts.

*Note: In some cases, in order to achieve proper caliper to rotor alignment, it may be required to grind a slight amount of material off the anchor bolt boss of the spindle to allow the disc brake caliper brackets to sit flush.*

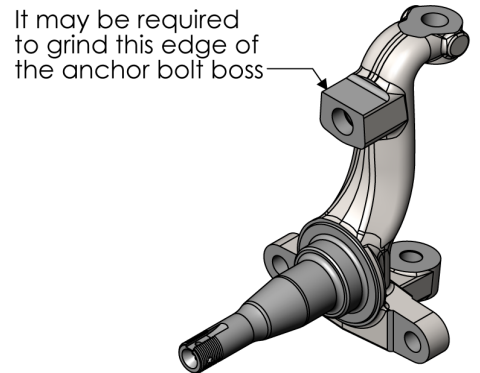

### Notes:

This kit will not work with O.E. disc brake spindles.

This kit is designed to work with 14" or larger disc brake wheels.

This kit will not work with 14" drum brake wheels.

When running drop spindles with CPP 10.75" brake kit and tubular upper control arms on 1962-67 Novas, CPP recommends using disc bracket kit #6267DBK-DSTCA.

### Replacement Parts:

Brake Calipers: 1982-1991 S-10 ton pickup 2 wheel drive  
 Brake Pads: 1982-1991 S-10 ton pickup 2 wheel drive  
 Brake Rotor: CPP 10.75" 31816

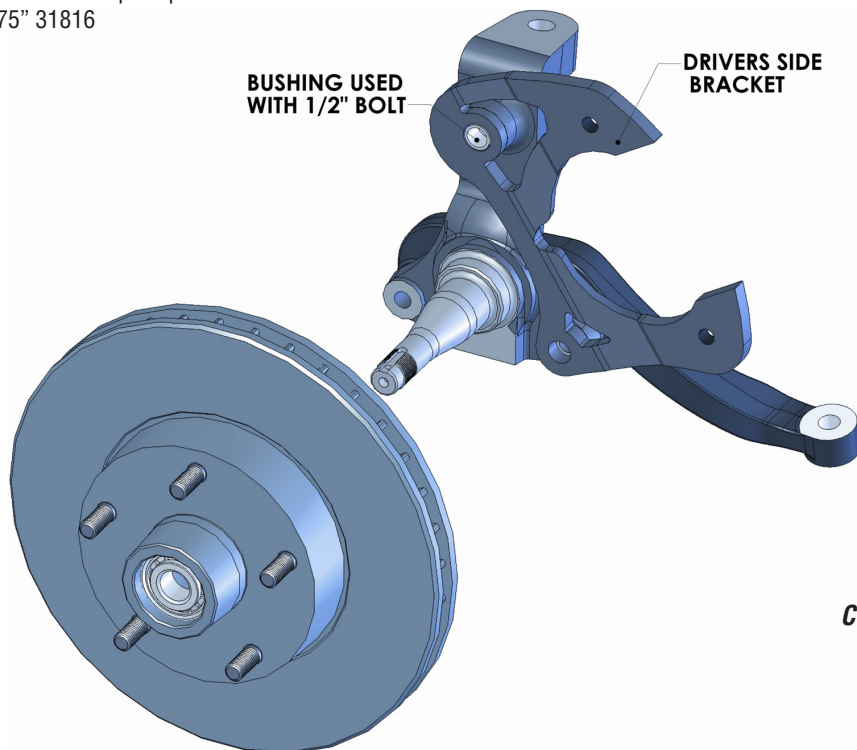

*Continued on next page*



Steering, Brake & Suspension Specialists

# #6467WBK-S - Installation Instructions for 1962-67 GM "X" Body 10.75" Brake Kit

4. Pack the wheel bearings with grease. Install the inner bearings and the grease seal. Install the new rotor assembly. Install the outer wheel bearing, washer and spindle nut. Adjust the wheel bearings as follows:
  - a. Tighten the nut only slightly (no more than 12lb/ft.) spin the rotor in a forward direction to ensure the bearings are fully seated.
  - b. Check that the spindle nut is still tight. If not repeat step a.
  - c. Loosen the spindle nut until it is just loose.
  - d. Hand tighten the spindle nut and install the cotter pin. Do not use a wrench! If necessary loosen the nut to the first position the cotter pin can be installed into.
5. Install the caliper assemblies. The bleed screws will be towards the top. Torque the caliper mounting bolts to 15 lbs/ft.
6. Check that the hub can turn freely and that the brakes do not drag.
7. Connect the new brake hoses to the calipers, and the hard lines. Secure the brake hoses to the frame with the brake hose clips.
8. Bleed the brakes.

GENERAL TORQUE SPECIFICATIONS:					
1/4"	grade 5	10lb/ft	1/4"	grade 8	14lb/ft
5/16"	grade 5	19lb/ft	5/16"	grade 8	29lb/ft
3/8"	grade 5	33lb/ft	3/8"	grade 8	47lb/ft
7/16"	grade 5	54lb/ft	7/16"	grade 8	78lb/ft
1/2"	grade 5	78lb/ft	1/2"	grade 8	119lb/ft
9/16"	grade 5	114lb/ft	9/16"	grade 8	169lb/ft
5/8"	grade 5	154lb/ft	5/8"	grade 8	230lb/ft

NOTE: With 18" and larger wheels we recommend 1/2" wheel studs. The larger the wheel diameter, the greater the force is on the wheel studs. Please inquire about replacement wheel stud kits available from CPP.

© Classic Performance Products, Inc. 2015  
All rights reserved. This document may not be reproduced without prior written permission of CPP.