

# #5864RTCA-L - Rear Lower Tubular Control Arm Instructions for 1958-64 Fullsize Chevrolet Car

### Parts List:

2 ea	Rear Lower Control Arm Assembly
4 ea	5/8-18x4 Bolt
4 ea	5/8-18 Lock Nut
8 ea	5/8 Flat Washer

### Instructions:

1. Remove the original lower links.
2. Using the hardware install the new lower links. The spring mount will be and to the rear.

**PLEASE NOTE:** The installer needs to make sure that nothing can make contact with a brake hose, caliper, or other brake component at any point through the entire range of steering and suspension movement. The installer also needs make sure none of the steering or braking components can become bound or jammed at any time through the range of suspension or steering movement.

### Recommendations:

In order to realize the maximum benefits of these arms, CPP recommends using the 5864RTCA-U rear tubular upper control arms with this kit.

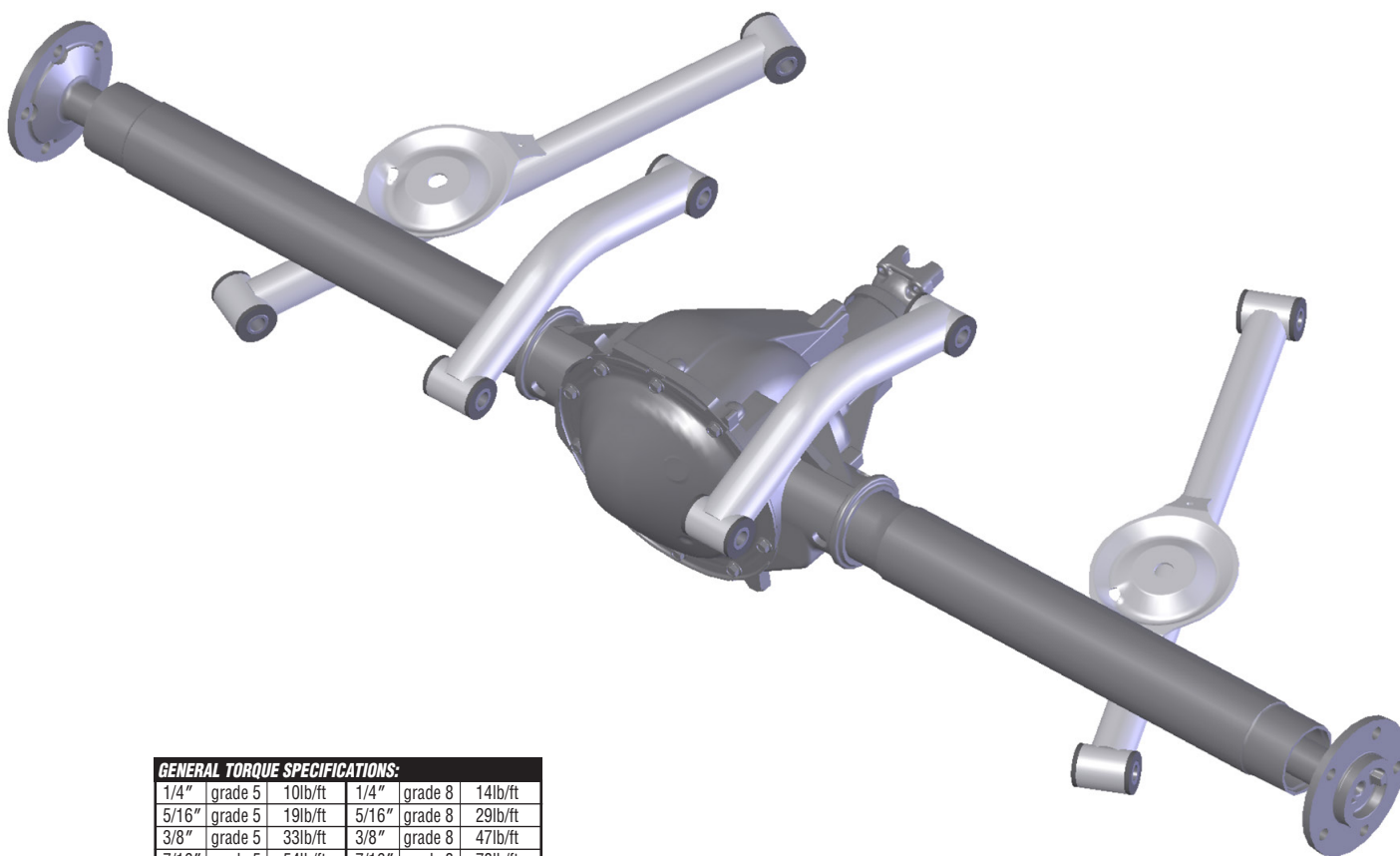

#### GENERAL TORQUE SPECIFICATIONS:

1/4"	grade 5	10lb/ft	1/4"	grade 8	14lb/ft
5/16"	grade 5	19lb/ft	5/16"	grade 8	29lb/ft
3/8"	grade 5	33lb/ft	3/8"	grade 8	47lb/ft
7/16"	grade 5	54lb/ft	7/16"	grade 8	78lb/ft
1/2"	grade 5	78lb/ft	1/2"	grade 8	119lb/ft
9/16"	grade 5	114lb/ft	9/16"	grade 8	169lb/ft
5/8"	grade 5	154lb/ft	5/8"	grade 8	230lb/ft

**NOTE:** With 18" and larger wheels we recommend 1/2" wheel studs. The larger the wheel diameter, the greater the force is on the wheel studs. Please inquire about replacement wheel stud kits available from CPP.

© Classic Performance Products, Inc. 2015  
All rights reserved. This document may not be reproduced without prior written permission of CPP.