

Steering, Brake & Suspension Specialists

#5356MMB - Hood Tilt Kit Installation Instructions for 1953-56 Ford Truck

Make sure this kit fits your application before painting or plating. Parts that have been painted, plated or modified may not be returned.

One or two assistance are required for this installation, do not attempt to install alone!

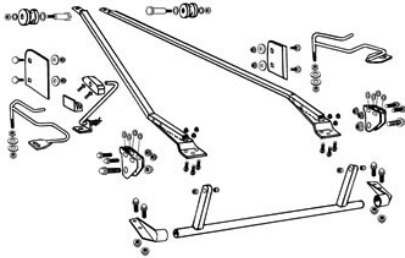

1. While supporting the hood, remove the hinges from the hood and carefully place the hood upside down on a surface that will not damage it.

2. Unbolt the support rods and then wiggle them back and forth to loosen

the plug-welded areas. The paint will usually crack and reveal the welds.

3. Drill out the welds to remove the support rods. Be careful not to drill in too far. Using a socket or two slipped over the drill as a depth gauge will help prevent damage.

4. After bolting the underhood framework together, bolt it to the existing holes with the supplied hardware.

5. Measure to ensure that the framework is properly centered on the front edge of the hood.

6. Trim a small portion of the metal lip on the underside of the hood with a die grinder. After the framework is positioned, mark the area. Then file the cut areas smooth.

7. The rubber gap will need to be trimmed to match the cutoff metal lip

8. Drilled new holes in the hood to mount the framework, a deep-well socket can be used as a standoff to keep the drill from punching through the other side.

9. Bolt the Teflon rollers to the existing holes. Secure with the nut.

10. Remove the old hinges from the truck.

11. Remove the bolt from the top of the inner fender area in preparation for installing the track.

12. Slide the stud on the track down into the hole and secure with the nut from underneath the fender.

13. Mount the stainless steel dress-up plate to the area where you removed the old hinge using one of the existing holes for the framework's hinge. Put the bolt in, then grease the inside of the tube. Slip the crossbar for the hinge into the two ends by sliding one of them sideways.

14. Once the crossbar in place, drill the second hole on each side to secure the crossbar hinge. This is where the prop rod attaches to when the hood is propped open.

15. Very, very carefully, line the hood up for reattachment. Watch all the corners, and protect the fenders with towels or blankets.

16. While supporting the hood, attach the crossbar to the framework under the hood. Close the hood a few times (very carefully) to make sure everything is lined up properly.

17. Measure back the appropriate distance and drill two holes to attach the prop rod.

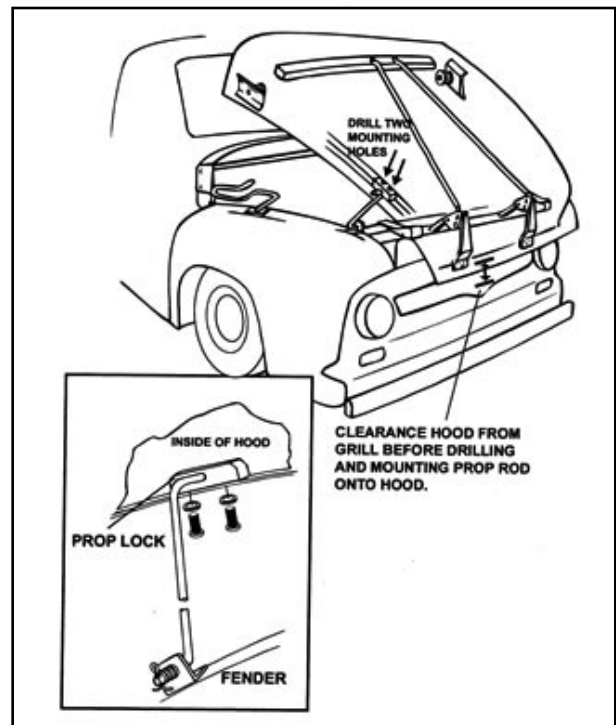

For technical help call Classic Performance Products Monday thru Friday 8:30am to 5:00pm at (714) 522-2000.

Classic Performance Products, Inc. 714.522.2000 | fax 714.522.2500

378 E. Orangethorpe Ave. | Placentia, CA 92870 | www.classicperform.com