

Steering, Brake & Suspension Specialists

#4759TRE - Eccentric Tie Rod Installation Instructions

Notes:

Make sure this kit fits your application before painting or plating. Parts that have been painted, plated or modified may not be returned.

CAUTION: Safe chassis repairs require specialized tools, techniques and experience. These parts should be installed by competent, professional mechanics. Injury to the installer and unsafe vehicle conditions can result from this installation by a person other than experienced mechanics.

Instructions:

1. Grind off peening on old ball studs until it is flush with the bar. Do not grind too far on the bar, you should grind until you see a ring where the ball stud is flush with the face of the bar. To help loosen the ball stud, you can place it in a strong vice and twist the bar back and forth.
2. Drive out the old ball studs with a centerpunch and hammer. It may take a few strong blows to remove the stud.
3. Assemble the new style eccentric sockets and tie rod including dust cover and spring. Insert the thread end into the steering arm.
4. Screw on the nut and insert the cotter pin.

**Note: With stock axle, tie rods install from the top as shown below. With drop axle, tie rod ends install from the bottom.*

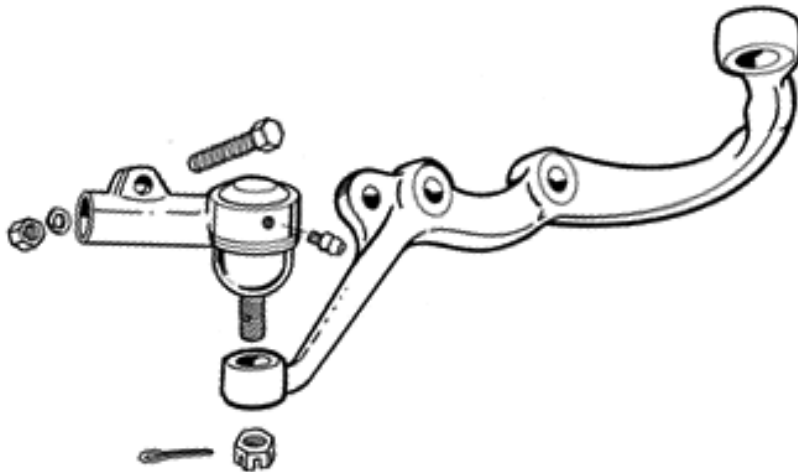
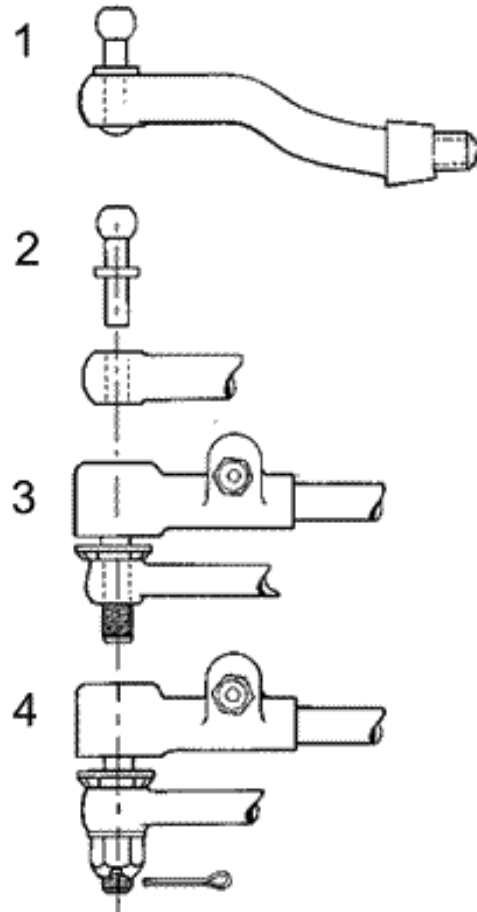

For technical help call Classic Performance Products Monday thru Friday 8:30am to 5:00pm at (714) 522-2000.

Classic Performance Products, Inc. 714.522.2000 | fax 714.522.2500

378 E. Orangethorpe Ave. | Placentia, CA 92870 | www.classicperform.com